

8 7 6 5 4 3 2 1

D

D

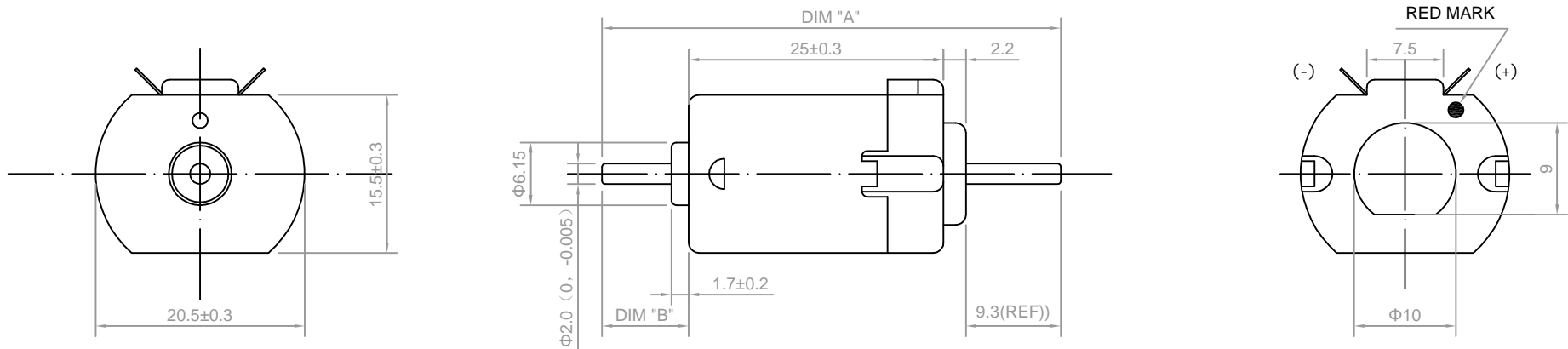

C

C

NOTES:

- 1、 Unit: mm;
- 2、 Length of shaft DIM "A" 45mm;
- 3、 Front extension DIM "B" 8.5mm;
- 4、 End play : 0.05-0.6mm;
- 5、 All unspecified dimension tolerance will be ± 0.10 mm.

B

B

No.	Item	Specification	No.	Item	Specification	Drawn	Bruce	11/03/2020
1	Rated Voltage	12.0V DC	7	No load current	0.45A Max	Checked	Eva	11/03/2020
2	Rated Power Output	13.03 W	8	No load speed	36000 \pm 10% rpm	Eng Appr.		
3	Direction of Rotation	CCW	9	Started Torque	218g.cm	Mfg Appr.		
4	Rated load current	2.9A Max	10	Stall current	7.7A Max	Q.A.		
5	Rated load speed	24000 \pm 10% rpm				SKU:		
6	Rated Torque	53g.cm				1112304		

Kysan Electronics
www.kysanelectronics.com

Size: A4 Unit: mm
 Scale: Sheet: 1 of 1

8 7 6 5 4 3 2 1

A

A