

KYSAN SKU: 1112359
 MFG: UC-130S-2480PW
 Rated Voltage: 12.0 VDC
 No Load Speed: 39000 RPM
 No Load Current: 0.45A
 Rated Power Output: 14.1 W
 Started Torque: 193 g-cm
 Ambient Temperature: 25° C

	Speed	Current	Torque	Efficiency	Power Out	Power In
	RPM	Amps	Grcm	%	W	W
Locked Rotor	0	5.502	193.658	0	0	63.963
Max Torque	0	5.502	193.658	0	0	63.963
Max Efficiency	22641	5.523	60.839	48	14.146	29.336
Max Watt (out)	16442	3.339	97.206	42	16.413	38.817

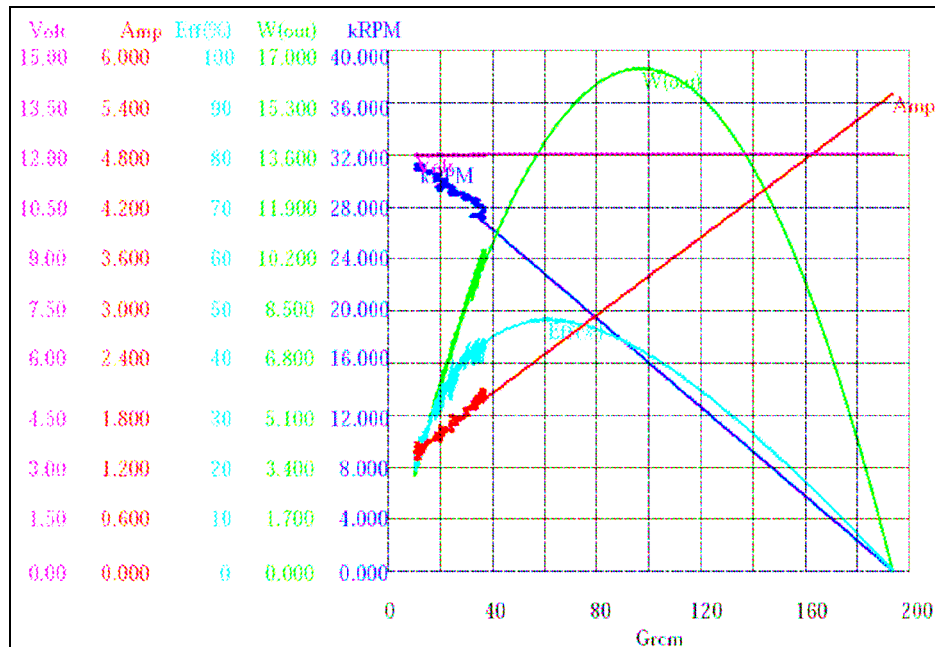

Unit: mm

REV	A3
-----	----

DIRECTION OF ROTATION

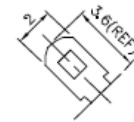
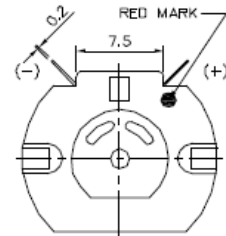
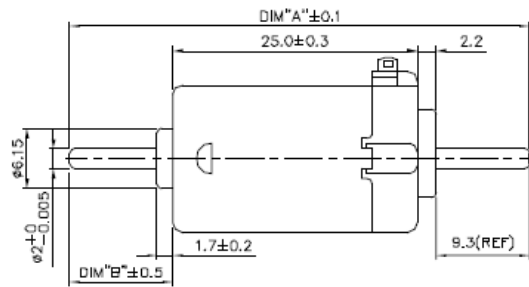
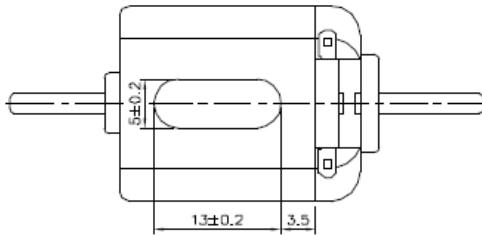
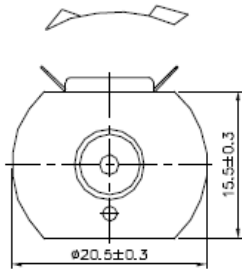

- NOTE :
- 1.LENGTH OF SHAFT DIM "A" 47.0 mm.
 - 2.FRONT EXTENSION DIM "B" 10.5 mm.
 - 3.END PLAY : 0.05-0.60 mm.
 - 4.ALL UNSPECIFIED DIMENSION TOLERANCE WILL BE ±0.10 mm.